

Key Nr.	Qty.	PART NAME	Reference Number	Key Nr.	Qty.	PART NAME	Reference Number
46	1	Carburetor body	Not supplied	70	2	Spring for idle mixture adjusting screw	47600.007
46	1	Gasket for bowl bottom cover	41640.041	71	2	Spring cup	58000.008
47	1	Bowl bottom cover	32374.046	72	2	Idle adjusting screw "O" ring seal	41656.002
48	4	Washer	55510.034	73	2	Progression holes chamber blanking screw	61045.002
49	1	Bowl bottom cover fixing screw	45002.049	74	2	Pump jet gasket	41593.021
50	1	Accelerator pump control lever	59405.041	75	2	Pump jet	74601.045*
51	1	Spring pin	41640.021	76	2	Pump jet "O" ring seal	41685.009
52	1	Gasket	64370.009	77	2	Pump jet chamber blanking screw	61045.008
53	2	Plate fixing screw	52135.002	78	1	Intake and back bleed pump valve	74701.100*
54	1	Plate	60700.013	79	1	Float pivot	52000.001
55	1	Plate blanking choke	55655.045	80	2	Pump valve ball	58300.003
56	2	Plate fixing screw	48041.145	81	2	Stuffing bell	62700.001
57	1	Spring hooking washer	55655.044	82	2	Intake pump valve blanking screw	61045.008
58	1	Shaft return spring	47810.111	83	1	Screw plug for union	12716.008
59	1	Washer	55655.045	84	1	Gasket	12716.008
60	1	Main lever (48 DCOE 99/1)	48041.145	85	1	Fuel union	41530.024
61	1	Adjusting screw "O" ring seal (48 DCOE 99/1)	41685.002	86	1	Gasket	10354.001
62	1	Spring cup (48 DCOE 99/1)	58000.008	87	1	Strainer	41530.031
63	1	Adjusting screw spring (48 DCOE 99/1)	47800.007	88	1	Strainer inspection plug gasket	37022.002
64	1	Throttle plate adjusting screw (48 DCOE 99/1)	64585.005	89	1	Strainer inspection plug	41630.024
65	1	Pump plunger	58602.003	90	1	Jets inspection cover	61002.010
66	1	Pump loading spring	47500.008	91	1	Inspection cover gasket	32376.003
67	1	Pump spring securing plate	52140.004	92	5	Carburetor cover fixing screw	41550.002
68	1	Accelerator pump control rod	16410.018	93	5	Washer	64700.001
69	2	Idle mixture adjusting screw	64760.003				55510.034

(\*): Callbrated parts.

## SETTING

Key Nr.	Qty.	Reference Number	PART NAME	Setting in mm.
14	2	72117.020	Choke	.42
15	2	66819.450	Auxiliary venturi	4,50
13	2	73401.400	Main jet	1,80
7	2	77401.100	Air correction jet	1,80
9	2	61456.030	Emulsion tube	F 3
10	2	74821.060	Idle jet	F 0,90
76	2	76801.045	Pump jet	0,45
78	1	79701.100	Pump back bleed valve port	1,00
4	1	79803.250	Needle valve	2,50
—	—	—	Float level	7,75 - 8,25 (**)

Measrs. E. WEBER do not answer for eventual working anomalies due to arbitrary modifications introduced into the above setting.

## (\*\*) DIRECTIONS FOR LEVELLING THE FLOAT

It is essential that the following directions be complied with in order to obtain correct levelling of the float:

- Make sure (only for brass float) that the same does not show any plt. Check that float can freely slide on its axis.
- Make sure that needle valve is tightly screwed in its housing and that pin ball of the dampening device, incorporated in the needle, is not jammed.
- Keep the carburetor cover in vertical position, since the weight of the float could lower the pin ball fitted on the needle.
- Make sure that float clip is perpendicular to the needle and does not have any indentation on the contact surface which might affect the free movement of the needle itself.
- With carburetor cover in vertical position and float clip in light contact with the pin ball on the needle, the distance of float from upper surface of carburetor cover (with gasket fitted) must measure mm. 8 (for brass float) and mm. .... (for plastic float).
- Weber gauge number for brass float 98028.020.
- Weber gauge number for plastic float .....
- After the levelling has been done check that the stroke of brass float is mm. 6 and plastic float is mm. .... If necessary adjust the position of the lug.
- Check that return hook of the needle allows it free movement on its seat.

### NOTE

The operations of levelling the float must be carried out whenever it is necessary to replace float or fuel inlet needle valve; in this last case it is advisable to replace also the sealing gasket, making sure that the new needle valve is tightly screwed in its housing.



# WEBER CARBURETORS

Type 48 DCOE 98/1 - 99/1

CARBURETORS  
FOR SPECIAL  
APPLICATIONS

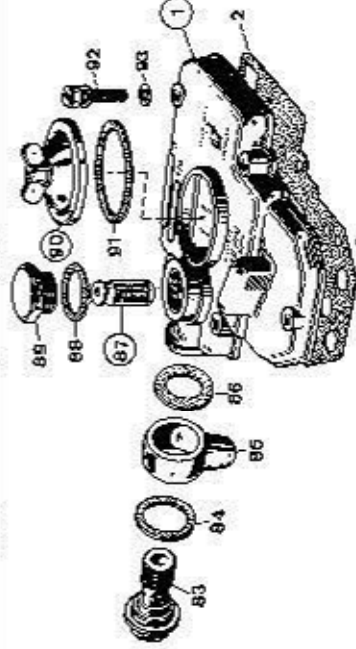

CARBURETOR REFERENCE NUMBER

48 DCOE 98/1 19830.001

48 DCOE 99/1 19830.002

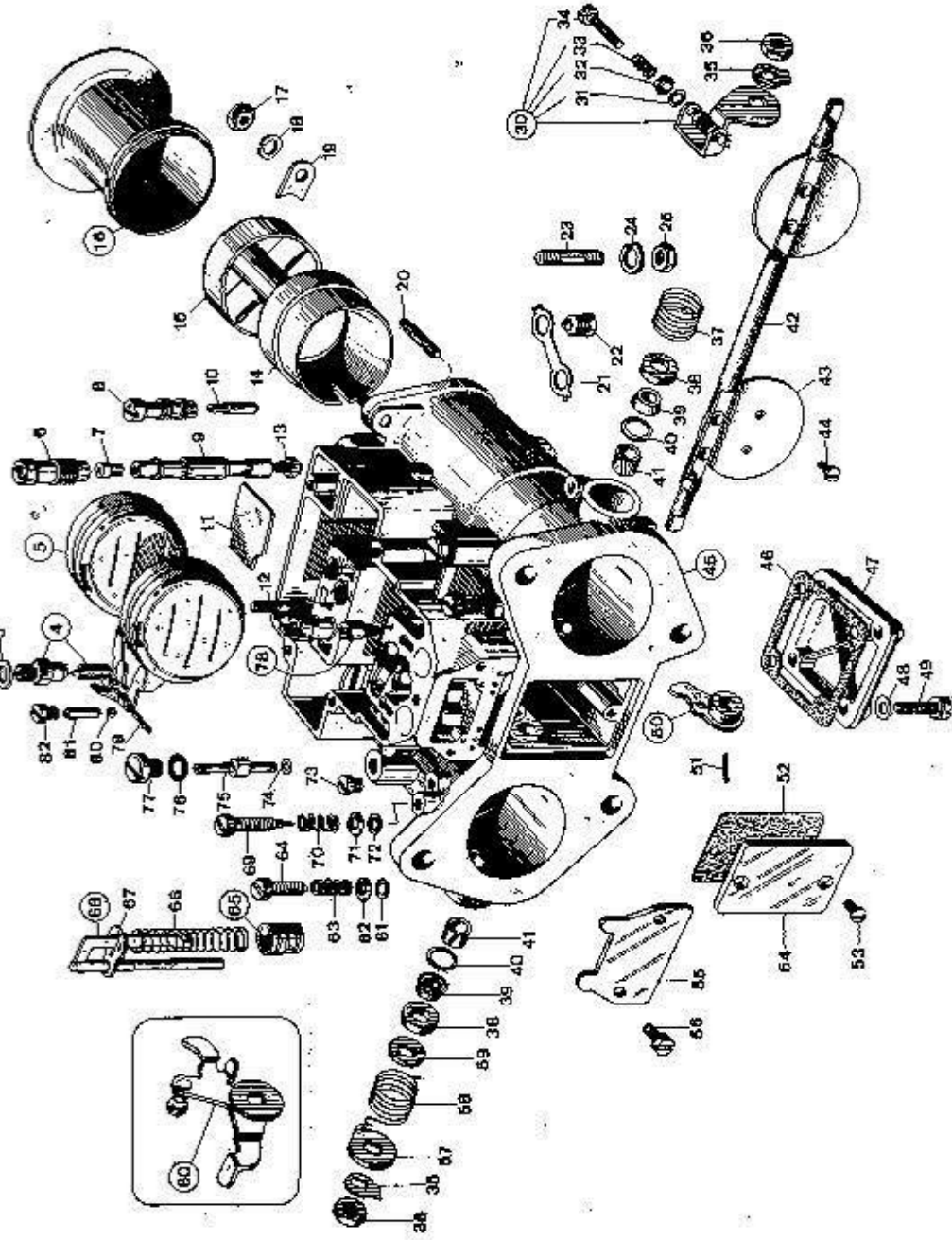

Orders: When placing orders, always mention reference number or requested part, as well as type and number of carburetor.

Key Nr.	Qty.	PART NAME	Reference Number	Key Nr.	Qty.	PART NAME	Reference Number
1	1	Carburetor cover	31734.13D	21	2	Lock plate	52155.008
2	1	Carburetor cover gasket	41715.601	22	4	Choke and auxiliary venturi fixing screw	84840.003
3	1	Needle valve gasket	82102.070	23	1	Stud for carburetor anchorage	64955.104
4	1	Needle valve	78503.450*	24	1	Spring washer	55625.002
5	1	Float	41030.085	25	1	Nut	34708.004
6	2	Emulsion tube holder	52540.001	30	1	Throttle plate control lever (48 DCOE 98/1) including: - "O" ring gasket	45041.147
7	2	Air correction jet	77401.190*	31	1	- Spring cup	41686.002
8	2	Idle jet holder	52585.008	32	1	- Spring	69000.006
9	2	Emulsion tube	61450.050*	33	1	- Screw	64828.015
10	2	Idle jet	74921.060*	34	2	Lock washer	56520.004
11	1	Plate	52190.803	35	2	Nut	34716.017
12	1	Stud	64955.007	36	2	Shut return spring	47610.116
13	2	Main jet	73401.180*	37	1	Washer	39555.048
14	2	Choke	72117.490*	38	2	Gasket	41575.010
15	2	Auxiliary venturi	69819.480*	39	2	Washer	53510.087
16	2	Float	52840.033	40	2	Throttle shaft bearing plate	52130.011
17	2	Air horn	84705.004	41	2	Throttle shaft	10095.482
18	4	Air horn fixing nut	56525.002	42	1	Throttle valve	64805.108
19	4	Spring washer	52190.037	43	2	Throttle valve fixing screw	64870.006
20	4	Air horn fixing stud	64955.104	44	4		