

28/32 ADHA

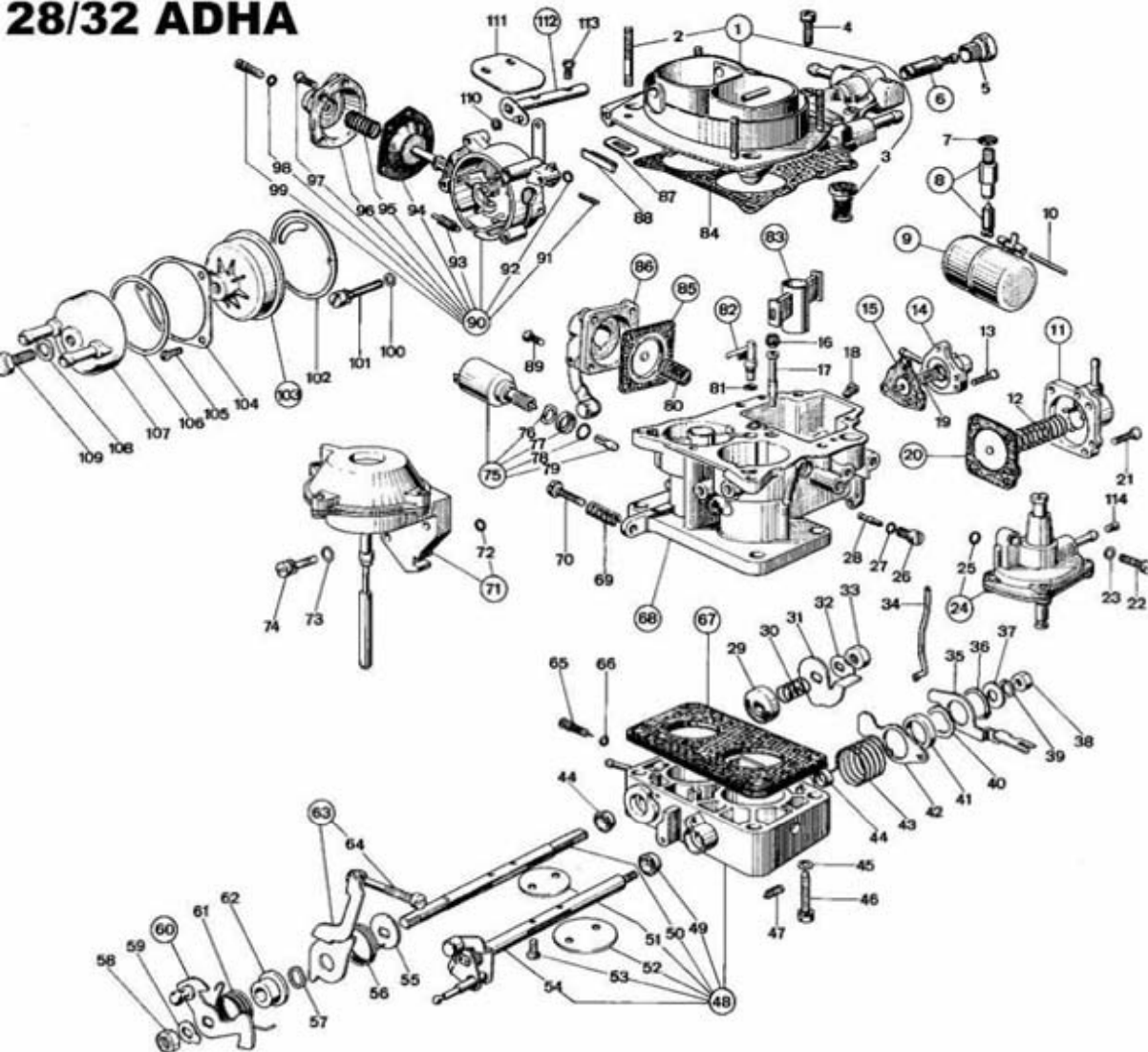

PARTS LIST

TYPE 28/32 ADHA – PART NO. 22560.006

Dia No.	Qty. Req'd	Description	Part Number	Dia No.	Qty. Req'd	Description	Part Number
1	1	Top Cover	Not Serviced	58	1	Throttle Shaft Fixing Nut	34715.014
2	4	Top Cover Stud	64955.007	59	1	Shaft Lock Tab	55520.002
3	1	Plunger	64372.009	60	1	Throttle Lever	45027.137
4	6	Top Cover Fixing Screw	64700.005	61	1	Spring	Not Serviced
5	1	Plug	61002.019	62	1	Bushing	12775.075
6	1	Fuel Screen	37022.004	63	1	Lever	45069.055
7	1	Needle Valve Gasket	83102.070	64	1	Screw	64590.010
8	1	Needle & Seat	79510.+++	65	1	Mixture Screw	64750.051
9	1	Brass Float	41015.004	66	1	O-Ring	41565.010
10	1	Float Pin	52000.015	67	1	Flange	39152.019
11	1	Auxiliary Pump Cover	32486.080	68	1	Carburetor Body	Not Serviced
12	1	Auxiliary Diaphragm Spring	47600.175	69	1	Spring	47600.094
13	3	Screw	64565.001	70	1	Screw	64895.011
14	1	Power Valve Cover	32386.024	71	1	Capsule	31800.047
15	1	Diaphragm	47407.156	72	1	O-Ring	41565.008
16	1	Air Corrector Jet	77201.*	73	2	Washer	55510.034
17	1	Emulsion Tube	61440.*	74	2	Top Cover Fixing Screw	64700.005
18	1	Main Jet	73801.*	75	1	Idle Cut Off Solenoid	43903.055
19	1	Spring	47600.171	76	1	Wavy Washer	55530.016
20	1	Diaphragm	47407.163	77	1	Plate	58000.019
21	4	Screw	64565.001	78	1	O-Ring	41565.001
22	2	Screw	64700.011	79	1	Idle Jet	74409.*
23	2	Washer	55510.018	80	1	Pump Loading Spring	47600.092
24	1	Capsule	31800.046	81	1	O-Ring	41565.001
25	1	O-Ring	41565.008	82	1	Pump Jet	76407.*
26	1	Idle Jet Holder	52570.006	83	1	Auxiliary Venturi	70508.450
27	1	O-Ring For Idle Jet Holder	41565.002	84	1	Top Cover Gasket	41705.049
28	1	Idle Jet	74403.*	85	1	Diaphragm	47407.118
29	1	Shaft Bushing	50002.008	86	1	Accelerator Pump Cover	32486.069
30	1	Bush Retaining Spring	47600.027	87	1	Dust Seal Plate	52135.018
31	1	Lever	Not Serviced	88	1	Dust Seal Plug	61070.002
32	1	Shaft Lock Tab	55520.004	89	4	Screw	64565.001
33	1	Throttle Spindle Nut	34710.003	90	1	Starting Device	57804.321
34	1	Rod Arm	Not Serviced	91	1	Spring	Not Serviced
35	1	Lever	Not Serviced	92	1	O-Ring	41565.008
36	1	Spring Ring	10140.304	93	1	Spring	47605.031
37	1	Washer	55510.081	94	1	Diaphragm	47407.149
38	1	Nut	34705.001	95	1	Pump Loading Spring	47600.092
39	1	Lock Washer	55525.003	96	1	Cover	32384.039
40	1	Washer	12750.103	97	3	Screw	64560.004
41	1	Bushing	12750.103	98	1	O-Ring	41565.010
42	1	Spring Retainer	Not Serviced	99	1	Screw	64895.010
43	1	Spring	47610.102	100	2	Washer	55510.034
44	2	Bushing	41575.010	101	2	Top Cover Screw (Long)	64695.021
45	2	Washer	55510.034	102	1	Auto Choke Body Gasket	41640.052
46	2	Screw	64700.016	103	1	Choke Element	57804.298
47	1	Screw	64595.013	104	1	Choke Lock Ring	52135.029
48	1	Lower Body	Not Serviced	105	3	Screw	64615.004
49	1	Bushing	41575.010	106	1	Water Cover Gasket	41555.001
50	1	Primary Throttle Shaft	Not Serviced	107	1	Water Choke Cover	32444.011
51	1	Primary Throttle Plate	Not Serviced	108	1	Gasket	41530.002
52	1	Secondary Throttle Plate	Not Serviced	109	1	Screw	64610.008
53	4	Screw	64520.027	110	1	Spring Ring	10140.501
54	1	Secondary Throttle Shaft	Not Serviced	111	1	Throttle Valve	64010.034
55	1	Washer	55555.054	112	1	Choke Shaft	10015.274
56	1	Spring	47610.144	113	2	Choke Plate Fixing Screw	64525.003
57	1	Wavy Washer	55530.002	114	1	Screw	64570.005
		*Calibrated Parts Require 3 Digits To Complete Part Number				+++ Call For Sizes.	
		See Calibrated Parts Section For Sizes.					